

FOR SALE: Former Credit Union Branch

5658 Dixie Highway
Saginaw, MI 48601



PROPERTY OVERVIEW

Office/Retail/Financial Institution building available on Dixie Highway in Bridgeport Township just south of King Road. Great visibility, with plenty of parking on a busy road with three drive-thru lanes and plenty of parking.

- + Available Space: 6,523 SF
- + Lot Size: 1.61 acres
- + 2023 SEV: \$333,400
- + Annual Taxes: \$13,442
- + Sale Price: \$350,000
- + Year Built: 1981
- + Zoning: C-1 Traditional Commercial
- + Parcel Numbers: 09-11-5-09-2017-000 & 09-11-5-09-2051-000

NO RESTRICTIONS ON FINANCIAL INSTITUTIONS

www.trademarkcommercial.com



FOR SALE: Former Credit Union Branch

5658 Dixie Highway
Saginaw, MI 48601



CONTACT US

Gretchen Witherspoon, SIOR, CCIM

Broker/Owner

(989) 792-6400 (office)

(989) 295-0353 (cell)

gretchenw@charter.net



www.trademarkcommercial.com

FOR SALE: Former Credit Union Branch

5658 Dixie Highway
Saginaw, MI 48601



CONTACT US

Gretchen Witherspoon, SIOR, CCIM

Broker/Owner

(989) 792-6400 (office)

(989) 295-0353 (cell)

gretchenw@charter.net



www.trademarkcommercial.com

FOR SALE: Former Credit Union Branch

**5658 Dixie Highway
Saginaw, MI 48601**



CONTACT US

Gretchen Witherspoon, SIOR, CCIM

Broker/Owner

(989) 792-6400 (office)

(989) 295-0353 (cell)

gretchenw@charter.net



www.trademarkcommercial.com

FOR SALE: Former Credit Union Branch

5658 Dixie Highway
Saginaw, MI 48601



GIS MAPPING



Property dimensions as depicted are approximate and subject to survey.

Source: Saginaw County GIS

CONTACT US

Gretchen Witherspoon, SIOR, CCIM

Broker/Owner

(989) 792-6400 (office)

(989) 295-0353 (cell)

gretchenw@charter.net



www.trademarkcommercial.com

FOR SALE: Former Credit Union Branch

5658 Dixie Highway
Saginaw, MI 48601



BUILDING FOOTPRINT

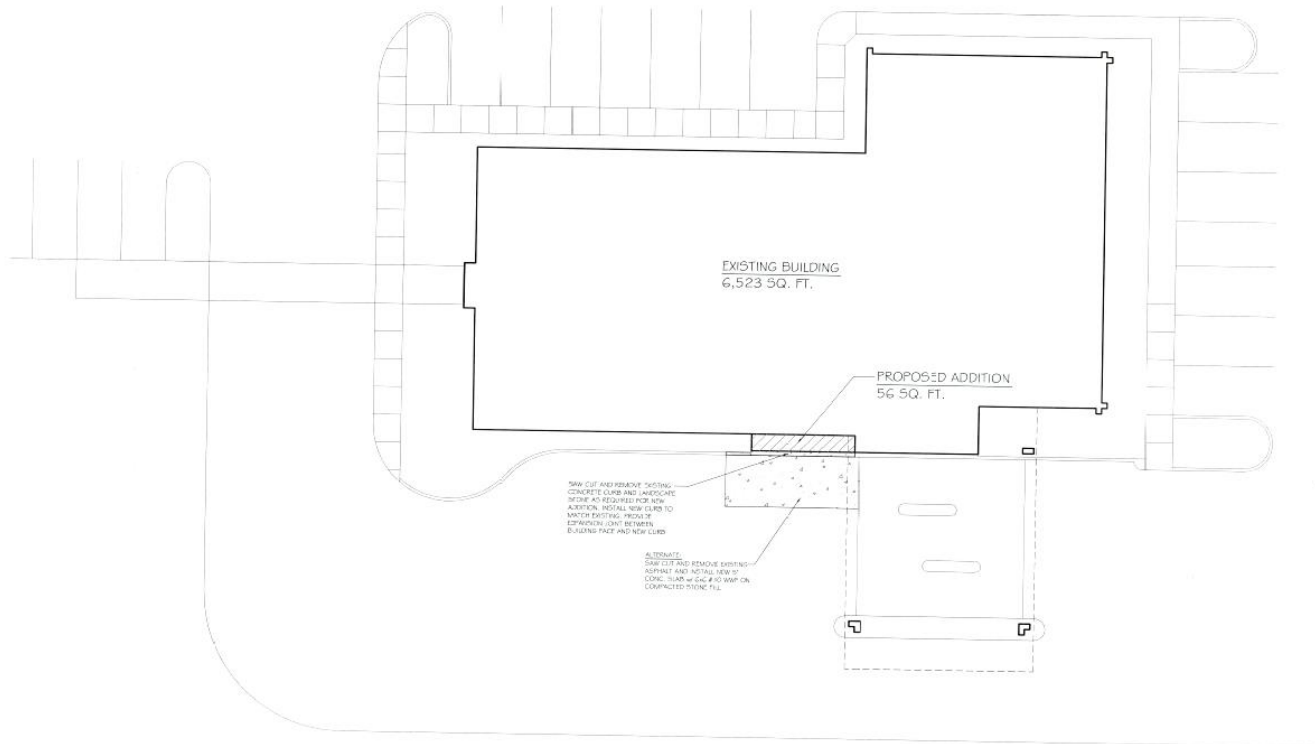

CONTACT US

Gretchen Witherspoon, SIOR, CCIM

Broker/Owner

(989) 792-6400 (office)

(989) 295-0353 (cell)

gretchenw@charter.net



www.trademarkcommercial.com

FOR SALE: Former Credit Union Branch

5658 Dixie Highway
Saginaw, MI 48601



AERIAL MAP



PROPERTY HIGHLIGHTS

- + Access: Ingress and egress Dixie Highway
- + Large rear parking lot, parking on side, and in front of, building
- + Multiple closed-door offices and conference rooms
- + Finished basement
- + # of Drive-Thru Lanes: 3



DEMOGRAPHICS

2020 DEMOGRAPHIC PROFILE

	5 Mile	10 Miles	20 Miles
Total Population	40,517	133,184	323,158
Households	17,236	57,204	136,072
Avg HH Income	\$45,711	\$68,606	\$75,536
Median HH Income	\$29,141	\$47,024	\$54,099
Median Home Value	\$56,641	\$120,214	\$144,085

CONTACT US

Gretchen Witherspoon, SIOR, CCIM

Broker/Owner

(989) 792-6400 (office)

(989) 295-0353 (cell)

gretchenw@charter.net



www.trademarkcommercial.com

FOR SALE: Former Credit Union Branch

5658 Dixie Highway
Saginaw, MI 48601



LOCATION MAPPING

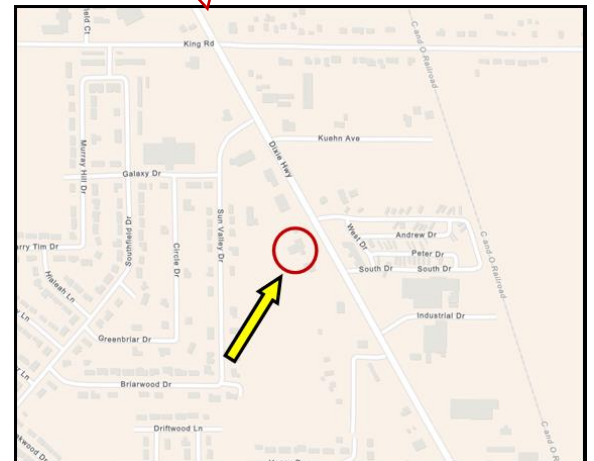
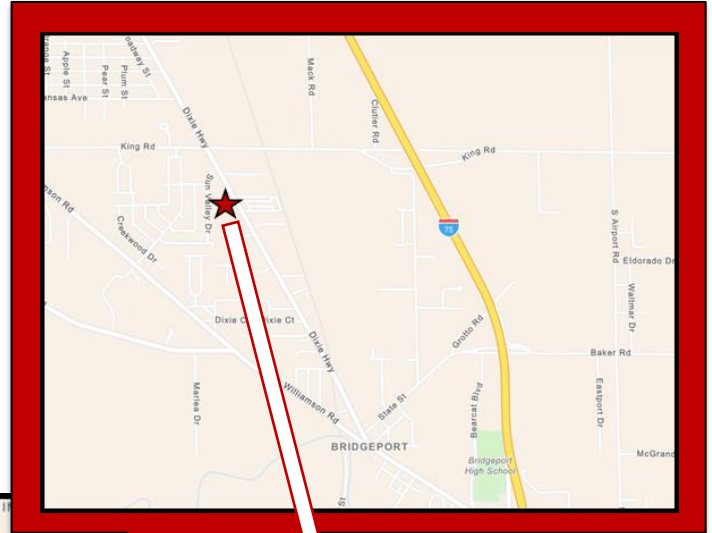
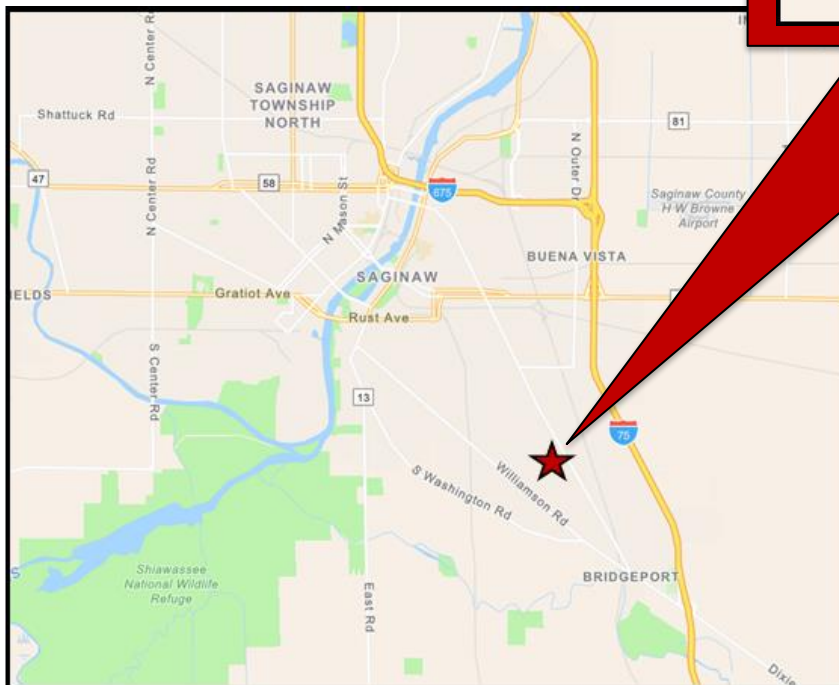

CONTACT US

Gretchen Witherspoon, SIOR, CCIM

Broker/Owner

(989) 792-6400 (office)

(989) 295-0353 (cell)

gretchenw@charter.net



www.trademarkcommercial.com